

ETAPE 1

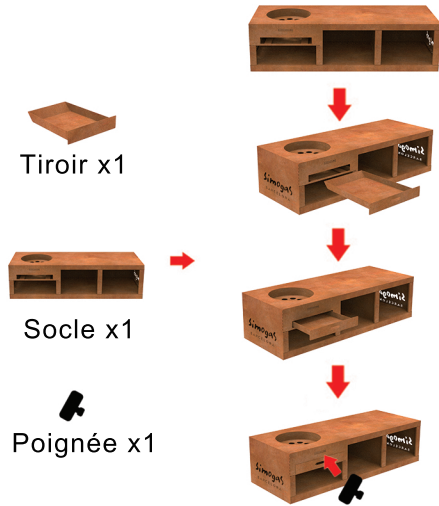

Insérez le tiroir dans le socle et installez la poignée sur le volet de la bouche d'aération.

ETAPE 2



Positionnez le bol sur le socle et attachez les ensemble à l'aide de la vis et de la rondelle.

ETAPE 3





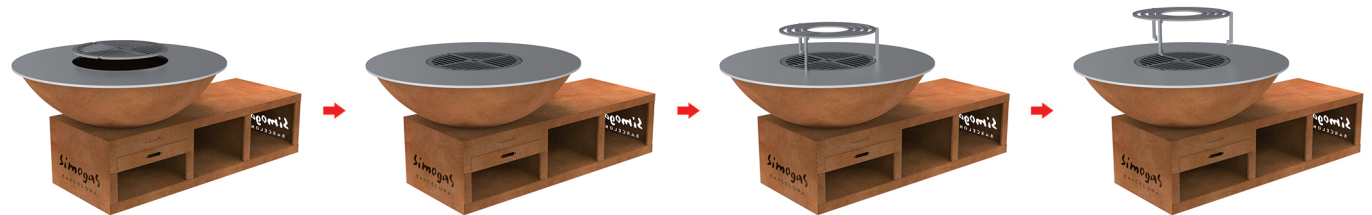

Placez la plaque sur le bol.

ETAPE 4

Placez la grille basse puis la grille haute.



-  Bol x1
-  Vis & rondelle x1
-  Plaque x1
-  Tiroir x1
-  Grille haute x1
-  Grille basse x1
-  Socle x1
-  Poignée x1